

## TAS-0.66 three-phase integrated Transformer

Combined transformer                      Model TAS-250

TAS-0.66    Three-phase integrated transformer

This series of molded case three-phase transformers can be installed with molded case circuit breakers to save space. It can be installed on a rail, which is convenient and fast.

TAS-0.66 three-phase integrated transformer

Product	Current ratio			Number of through-hole turns
		Level 1.0	Level 0.5	
 TAS-250	100/5	1		1
	150/5	1.5	1	1
	200/5	2.5	1	1
	250/5	2.5	1.5	1
	300/5	5	1.5	1

Product Dimensions↓↓

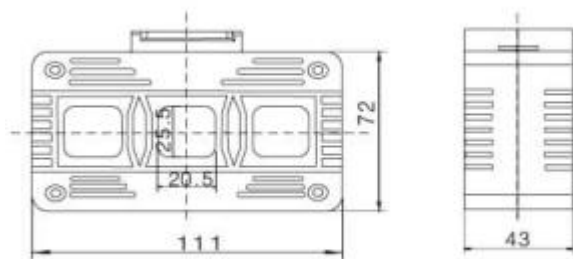

---

## BH-0.66 II type current transformer

Product Overview: BH-0.66 series current transformers are suitable for current, electric energy measurement or relay protection in AC lines with rated frequency of 50Hz, rated voltage of 0.66kV and below. The product is a molded case current transformer, which is widely used in complete cabinets. Its installation method can adopt busbar fixing and bottom plate fixing installation methods. It is suitable for installation in any direction. The primary conductor can be a busbar or a cable.

Working conditions and installation conditions:

- ◆Installation location: indoors.
- ◆Ambient temperature: -5℃~+40℃, daily average not exceeding +30℃.
- ◆Altitude: no exceeding 1,000m.
- ◆Atmospheric conditions: When the maximum temperature is +40℃, the relative humidity of the air shall not exceed 50%. At lower temperatures, the relative humidity shall not exceed 80%.
- ◆There shall be no serious pollution in the atmosphere, and there shall be no gas or conductive dust in the medium that is sufficient to corrode metal and damage insulation.
- ◆There shall be no severe vibration or bumps at the installation site.

### Ordering instructions:

1.Please specify the product model, window width, current ratio, rated output and corresponding accuracy level when ordering.

For example: Order BH-1.0 type, window width is 40mm, rated current ratio is 600/5A, rated output is 5VA, accuracy level is 0.2 transformer

System order description: BH-1.040600/50.2

2.The default values for loads not marked in the system are the parameters in the table, and the default values for levels not marked in the system are 0.5.

3.If you have other requirements, please indicate them in the contract.

Model BH-0.66 30I 200/5 0.5 Level (Single row)

Product	Current ratio	Rated secondary load (VA)					Number of through-hole turns
		Level 1.0	Level 0.5	Level 0.5S	Level 0.2	Level 0.2S	
 BH-0.6630I	100/5	1.5					1
	150/5	2.5	2.5				1
	200/5	2.5	2.5				1
	250/5	5	5	2.5	2.5	2.5	1
	300/5	5	5	5	5	5	1
	400/5	5	5	5	5	5	1

### Product Dimensions↓↓

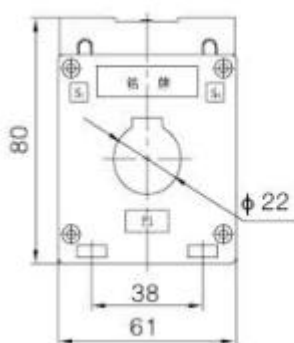

-----

Model BH-0.66 40I 300/5 0.5 Level (Single row)

Product	Current ratio	Rated secondary load (VA)					Number of through-hole turns
		Level 1.0	Level 0.5	Level 0.5S	Level 0.2	Level 0.2S	
 BH-0.66 40I	150/5	5	2.5				1
	200/5	5	5	5	5	5	1
	250/5	5	5	5	5	5	1
	300/5	5	5	5	5	5	1
	400/5	5	5	5	5	5	1
	500/5	5	5	5	5	5	1
	600/5	5	5	5	5	5	1

Product Dimensions↓↓

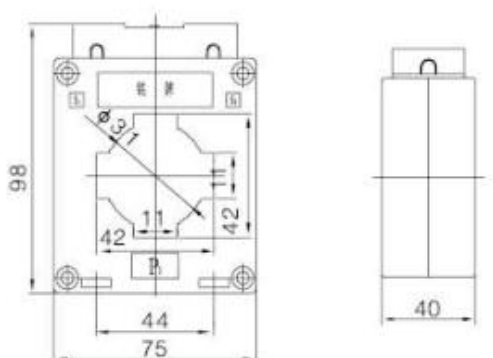

Model BH-0.66 80I 1200/5 0.5 Level (Single row)

Product	Current ratio	Rated secondary load (VA)					Number of through-hole turns
		Level 1.0	Level 0.5	Level 0.5S	Level 0.2	Level 0.2S	
 BH-0.66 80I	300/5	2.5	2.5				
	400/5	5			5	5	
	500/5	5	5	5	5	5	
	600/5	5	5		5		
	750/5	10	10	10	10	10	
	800/5	10	10	10	10	10	
	1000/5	10	10	10	10	10	
	1200/5	10	10	10	10	10	
	1500/5	10	10	10	10	10	
	2000/5	20	20	20	20	20	

Product Dimensions↓↓

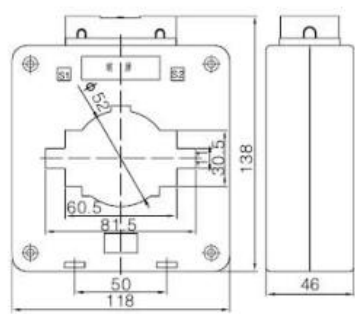

Model BH-0.66 120I 2000/5 0.5 Level (Single row)

Product	Current ratio	Rated secondary load (VA)					Number of through-hole turns
		Level 1.0	Level 0.5	Level 0.5S	Level 0.2	Level 0.2S	
 BH-0.66120I	800/5	10	10				
	1000/5	10	10	10	10	10	1
	1500/5	10	10	10	10	10	1
	2000/5	10	10	10	10	10	
	2500/5	20	20	20	20	20	
	3000/5	20	20	20	20	20	1
	4000/5	30	30	30	30	30	1

Product Dimensions↓↓

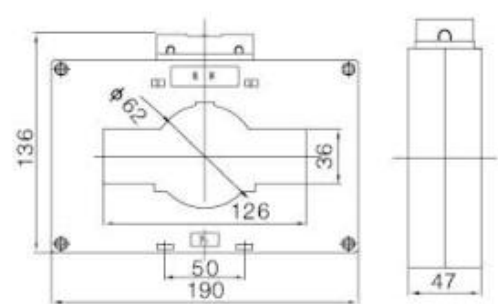

Model BH-0.66 60II 600/5 0.5 Level (Double row)

Product	Current ratio	Rated secondary load (VA)					Number of through-hole turns
		Level 1.0	Level 0.5	Level 0.5S	Level 0.2	Level 0.2S	
 BH-0.6660II	400/5	5	5	5	5	5	1
	500/5	5	5	5	5	5	1
	600/5	5	5	5	5	5	1
	750/5	10	10	10	10	10	1
	800/5	10	10	10	10	10	1
	1000/5	10	10	10	10	10	1
	1200/5	10	10	10	10	10	1
	1500/5	10	10	10	10	10	1

Product Dimensions↓↓

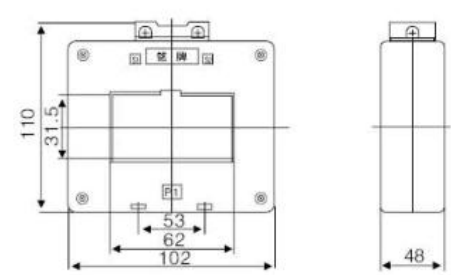

Ordering Instructions

- 1. Please specify the product model, window width, current ratio, rated output and corresponding accuracy level when ordering.  
For example: Order BH-0.66P type, window width is 60mm, rated current ratio is 800/5A, rated output is 5VA, composite error is 10P, protection multiple is 10 transformer  
System ordering description: BH-0.6660P 800/55VA10P10
- 2. If you have other requirements, please indicate them in the contract.

Protection level

Model **BH-0.66** 80P 1500/5 0.5 Level

Product		Protective rated secondary load (VA)			Measuring rated secondary load (VA)			
		5P5	10P10	10P15	Level 0.5	Level 0.2	Level 0.5S	Level 0.2S
 BH-0.6680P	800/5	5	2.5		10	10	10	10
	1000/5	10	5	2.5	10	10	10	10
	1200/5	10	5	5	10	10	10	10
	1500/5	15	10	5	10	10	10	10
	2000/5	20	10	5	20	20	20	20

Product Dimensions↓↓

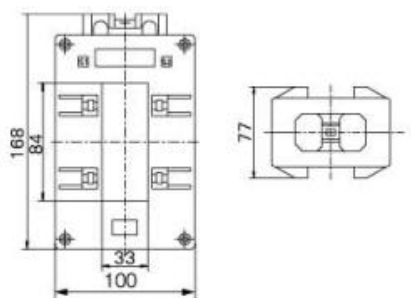

**BH-K series** split-type transformers are specially designed for easy installation in circuit or power grid transformation systems. They can be installed without disconnecting cables or buses. They are suitable for current and energy measurement in AC lines with a rated frequency of 50Hz and a rated working voltage of 0.66kV and below.

Open-and-shut type

Model **BH-100\*50K** 2000/5 0.5 Level

 BH-100*50K	1000/5		10	5	5	
	1200/5		10	5	5	
	1500/5		10	10	5	
	2000/5		15	10	10	
	2500/5		15	10	10	
	3000/5		20	10	10	

## Product Dimensions↓↓

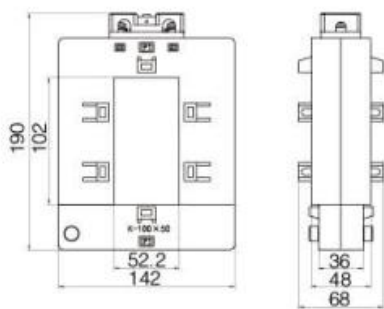

---

**LMZJ1-0.5 series** current transformers are suitable for current, electric energy measurement or relay protection in AC lines with rated frequency of 50Hz and rated voltage of 0.5kV and below. The product is a cast-type current transformer, and its installation method adopts base plate fixed installation.

### Working conditions and installation conditions:

- ◆ Installation location: indoors.
- ◆ Ambient temperature:  $-5^{\circ}\text{C} \sim +40^{\circ}\text{C}$ , daily average not exceeding  $+30^{\circ}\text{C}$ .
- ◆ Altitude: no exceeding 1,000m.
- ◆ Atmospheric conditions: When the maximum temperature is  $+40^{\circ}\text{C}$ , the relative humidity of the air shall not exceed 50%. At lower temperatures, the relative humidity shall not exceed 80%.
- ◆ There shall be no serious pollution in the atmosphere, and there shall be no gas or conductive dust in the medium that is sufficient to corrode metal and damage insulation.
- ◆ There shall be no severe vibration or bumps at the installation site.

## LMZJ1-0.5 series current transformer

Cast-in-place type	Model LMZJI-0.5	30I 100/5	0.5 Level
--------------------	-----------------	-----------	-----------

Product	Current ratio	Rated secondary load (VA)				Number of through-hole turns	Appearance
		Level 0.5	Level 0.5S	Level 0.2	Level 0.2S		
 LMZJ1-0.5 30 型	5/5	5		5	5	30	
	10/5	5	5	5	5	15	
	15/5	5	5	5	5	10	
	20/5	5	5	5	5	10	
	25/5	5	5	5	5	6	
	30/5	5	5	5	5	5	
	40/5	5	5	5	5	5	
	50/5	5	5			1	
	50/5	5	5	5	5	2	
	75/5	5	5	5	5	1	
	75/5	5	5	5	5	2	
	100/5	5	5	5	5	1	
	100/5	5	5	5	5	2	
	150/5	5	5	5	5	1	
	200/5	5	5	5	5		
	250/5	5	5	5	5	1	
	300/5	5	5	5	5	1	

## Product Dimensions↓↓

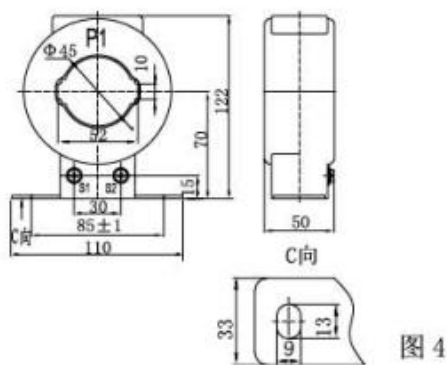

Cast-in-place type	Model LMZJI-0.5	40I 300/5	0.5 Level
--------------------	-----------------	-----------	-----------